

2220

ORDINANCE NO. _____

AN ORDINANCE amending King County Zoning Resolution No. 25789, as amended, by amending the Zoning Map thereof reclassifying certain property thereon at the request of Herbert R. Elving, Division of Land Use Management File No. 226-74-P.

BE IT ORDAINED BY THE COUNCIL OF KING COUNTY:

SECTION 1. Herbert R. Elving petitioned on April 1, 1974, that the property described in Section 3 below be reclassified from RS-7200 to RM-900 and this application was assigned Division of Land Use Management file No. 226-74-P.

SECTION 2. The report and recommendation of the Division of Land Use Management was transmitted to the Zoning and Subdivision Examiner on May 21, 1974 and hearing was held by the Examiner on the matter May 28, 1974. The report of the Examiner was filed with the Clerk of the King County Council on June 12, 1974 with Motion No. 1635.

SECTION 3. The legal description of the property to be reclassified is attached as Appendix A and is hereby made a part of this ordinance. The above described property is shown on the attached map which is designated Appendix B and is hereby made a part of this ordinance.

SECTION 4. The King County Council does hereby amend King County Zoning Code, Resolution No. 25789, as amended, by reclassifying that property described and shown in Section A and B above, to RM-900 and directs that Area Map W-4-21-4 be modified to so designate.

File No: 226-74-P
APPENDIX A

LEGAL DESCRIPTION:

Lot 13, Block 2 of Jeannette Soundview tracts as recorded in Volume 44 of plats pages 68 and 69 records of King County, Washington, less the easterly 327 feet as measured along the north and south lines, thereof.

The south 117 feet of the northwest quarter of the southwest quarter of Section 4, Township 21 North, Range 4 E.W.M., in King County, Washington, lying east of the State road known as Pacific Highway, described as follows:

Beginning at the intersection of the north line of the south 117 feet of said subdivision with the east margin of Pacific Highway;
thence east on said north line 140 feet;
thence southeasterly to a point on the south line of said sub-division which is 170 feet east of the east margin of said highway;
thence west on said south line 170 feet to the east margin of said highway;
Thence north along said margin to the point of beginning.

Applicant: Herbert R. Elving

APPENDIX B

Zone Change: RS-7200 to RM-900

STR: W 4-21-4

2220

Proposed
Reclassification

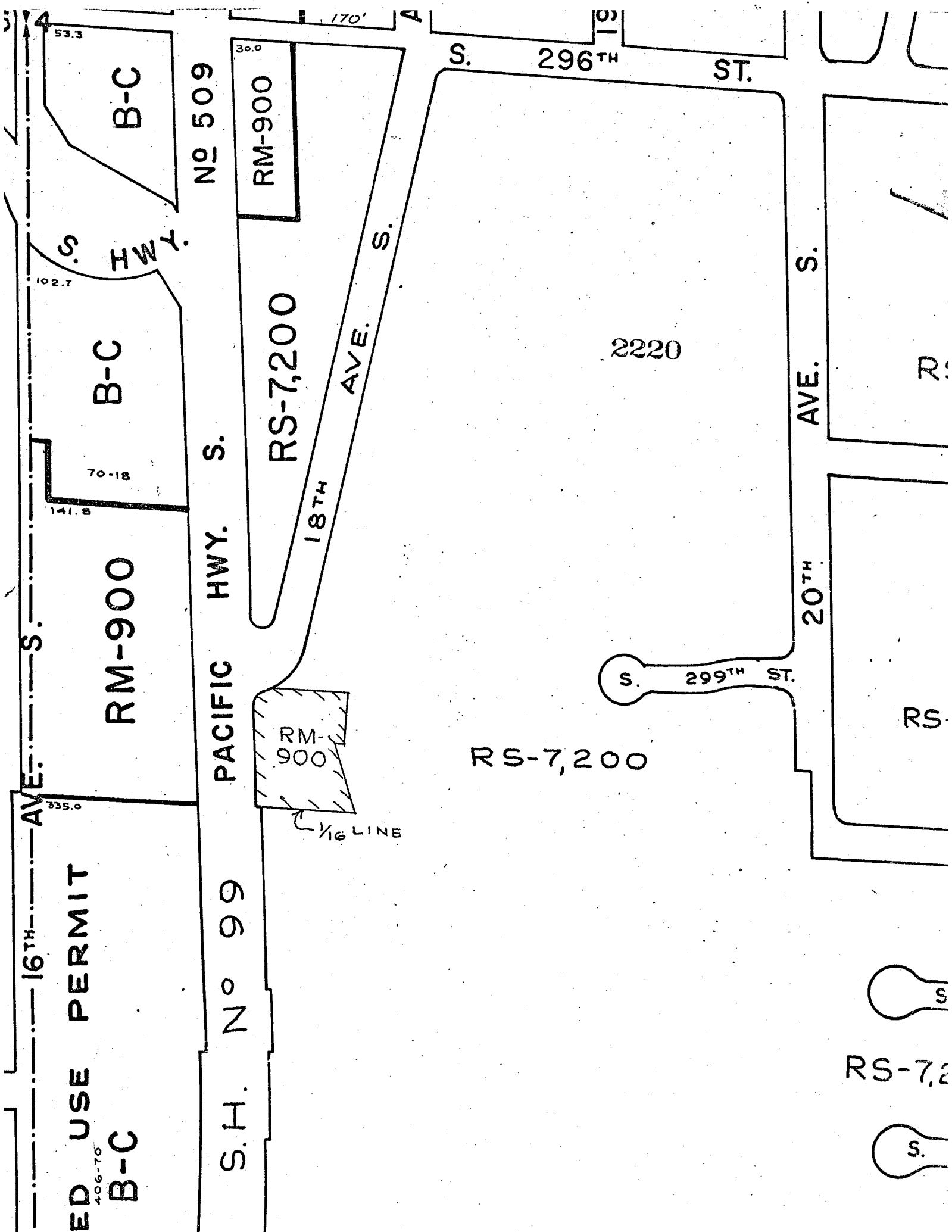
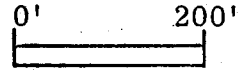

RS-7,200

